



HEIGHT SAFETY STRUCTURE

FSASS

Free Standing Access Stair System

LFAT

Lifeline Fall Arrest Trailer



BEAVER TECHNOLOGY SERVICES PTY LIMITED

FSASS INTRODUCTION

The **Free Standing Access Stair System (FSASS)** is ideal for use within the aviation industry as an overhead fall protection package in maintenance environments where engineers are constantly combating the issue of finding a solution for safe means of access and egress whilst working with a variety of aircraft with varying heights.

Key Product Features:

- Complies to AS/NZS5532
- The FSASS provides two (2) users with a portable means of accessing areas on multiple aircraft types via a full stairway set-up and provides overhead fall protection when working on the aircraft (from the ground to the work area).
- Adjustable outriggers enlarge the base footprint to stabilize and level the FSASS when in use and retract into the base of the stair to create a small and mobile unit for towing and transportation.
- Components are resilient to Skydrol and other aggressive chemical agents.
- Hi-visibility day & night tape as per IATA requirements – Airport Handling Manual AHM Basic Safety Requirements.
- Counter-weighted so it does not rely on the aircraft body as the support foundation.
- Can be easily maneuvered around a site utilising a tug or similar type of towing vehicle and can be positioned close to the aircraft by two individuals.
- Maximum free fall of 600mm for worker when used in conjunction with an approved inertia reel.

These systems feature a rugged steel base with various wheel options, while the upper structure is constructed of high quality lightweight aluminium tubing. This keeps the center of gravity as low as possible for improved stability during transport, operation and storage. Injection molded stair treads are made of impact resistant polyurethane, and feature unique open tread design which prevents build-up of ice, snow or other contaminants.



Manual Hydraulic Systems (Code: 70442)

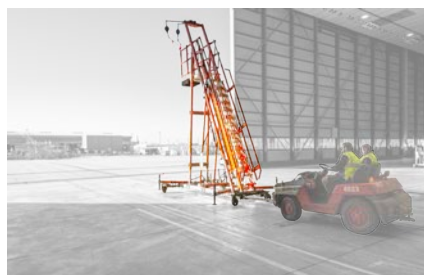

Can be towed up to 5kph



Easily positioned



Manual Winch Systems (Code: 70400 & 70407)

FSASS SYSTEM

Part No. 70400 & 70407 Free Standing Access Stair System

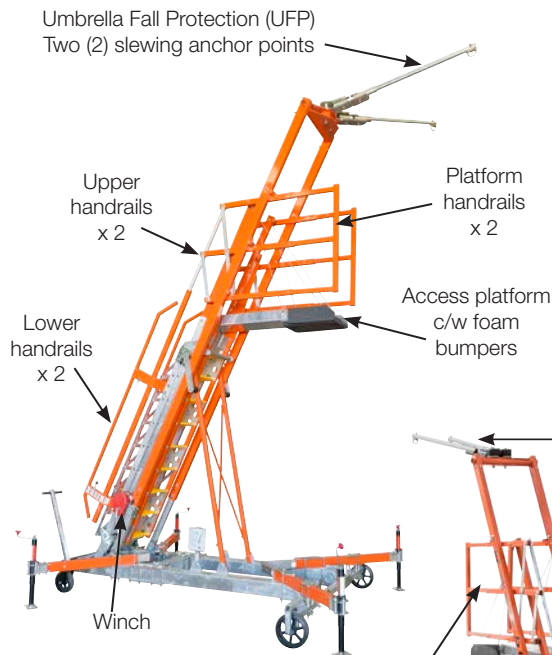

Winch mechanism to
raise platform

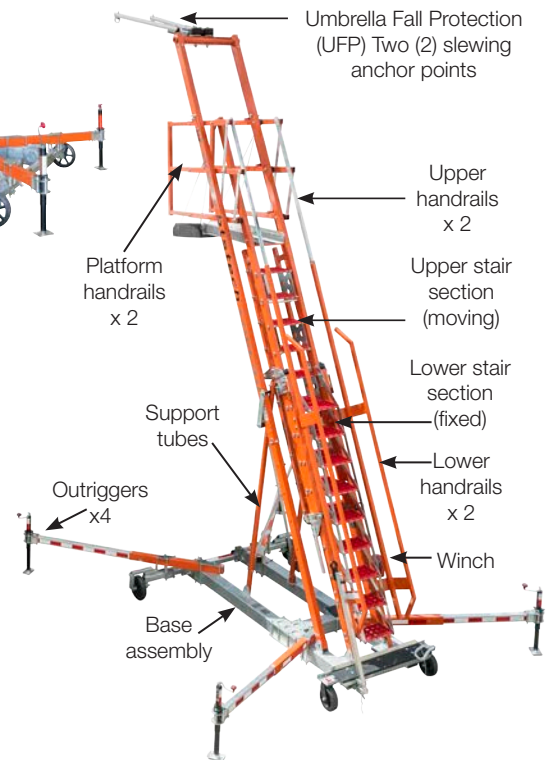

Hydraulic "Stepper"
mechanism to raise
platform

FSASS SAFE WORKING ZONE

Figures 2a, 2b & 2c show the safe working zones for FSASS with the Umbrella Fall Protection (UFP)

Figure 2a (below), Typical **Safe Working Zone** for fall protection applies to 70400

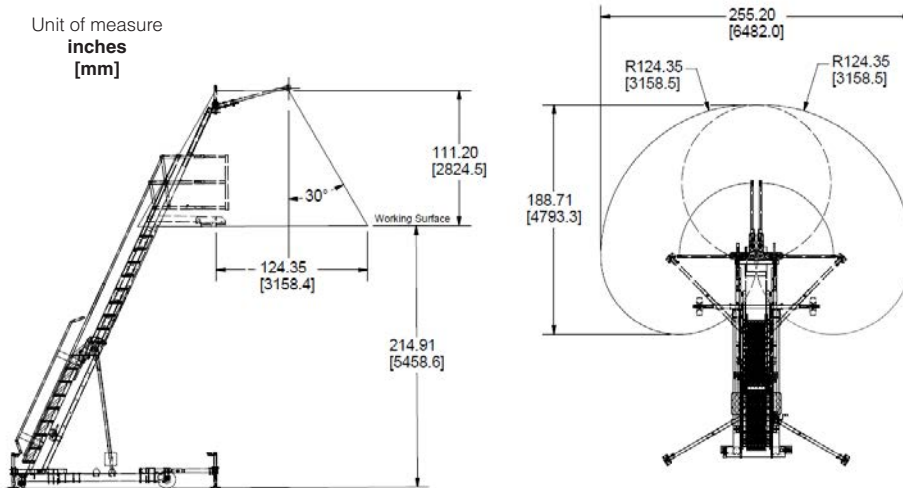

Figure 2b (below), Typical **Safe Working Zone** for fall protection applies to 70407

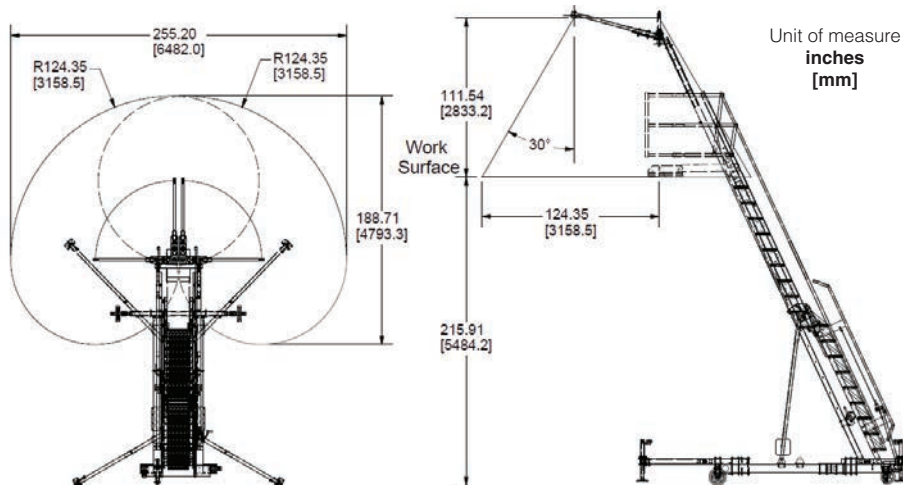
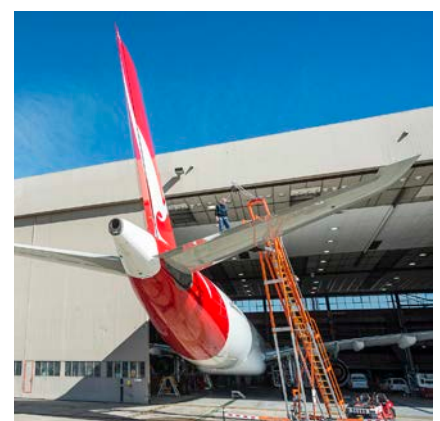
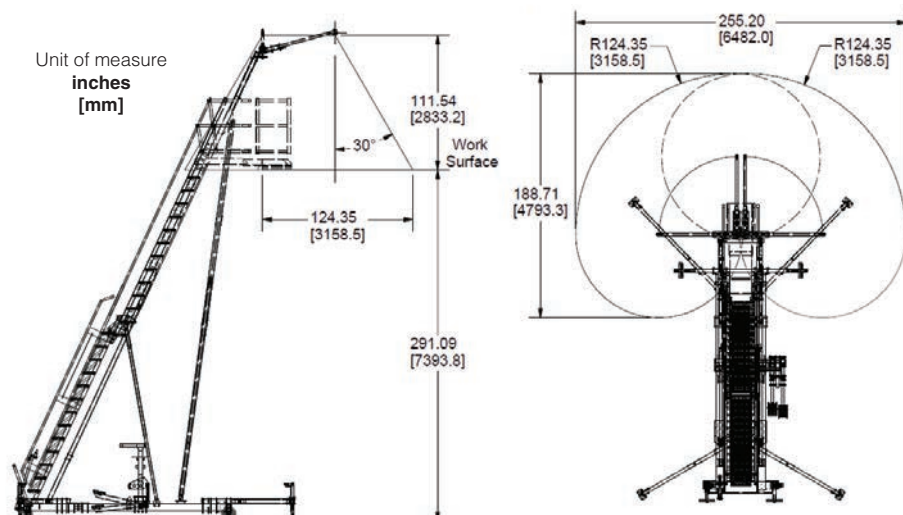
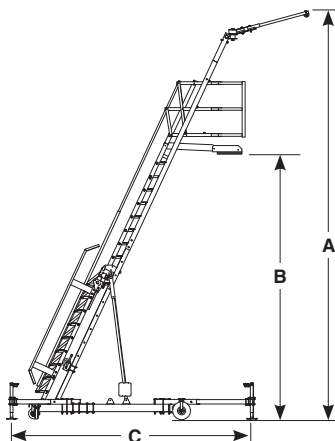

Figure 2c (below), Typical **Safe Working Zone** for fall protection applies to 70442



FSASS SPECIFICATIONS & AIRCRAFT HEIGHT

Model: 70400



Model: 70407

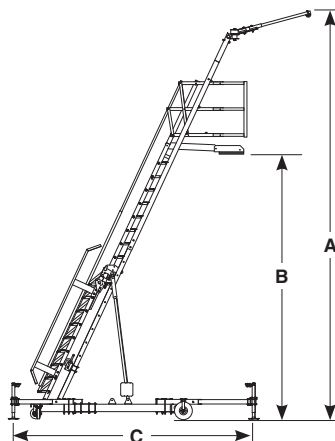

Model: 70442

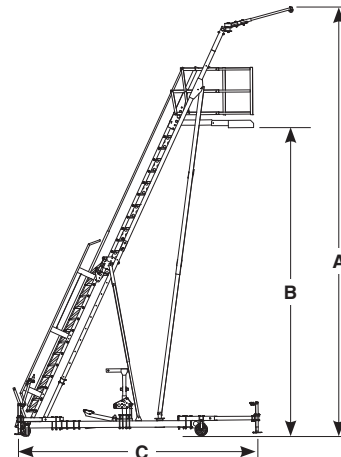

Part No.	Retracted Height (A)	Extended Height (A)	Platform Height (B)		Base Length (C)	
			Min.	Max.	Retracted	Extended
70400	6.0m	7.6m	3.0m	4.7m	3.2m	4.6m
70407	6.3m	8.6m	3.2m	5.6m	3.4m	4.4m
70442	7.3m	10.4m	4.4m	7.5m	5.0m	5.7m

Aircraft Model 747-400	Height
(1) Fuselage	9.8m
(2) Wing Tip	5.1m
(3) Wing / Fuselage	4.7m
(4) Tail Plane	8.0m
(5) Engine Nacelle	4.8m

Aircraft Model A380	Height
(1) Fuselage	10.7m
(2) Wing Tip	7.5m
(3) Wing / Fuselage	5.3m
(4) Tail Plane	7.5m
(5) Engine Nacelle	6.2 / 7.0m

Aircraft Model 787-800	Height
(1) Fuselage	7.6m
(2) Wing Tip	7.2m
(3) Wing / Fuselage	2.5m
(4) Tail Plane	6.7m
(5) Engine Nacelle	4.4m

Aircraft Model A350-900	Height
(1) Fuselage	8.5m
(2) Wing Tip	6.6m
(3) Wing / Fuselage	3.41m
(4) Tail Plane	7.64m
(5) Engine Nacelle	4.6m

Aircraft Model 777	Height
(1) Fuselage	8.3m
(2) Wing Tip	7.0m
(3) Wing / Fuselage	4.8m
(4) Tail Plane	7.5m
(5) Engine Nacelle	5.0m

Aircraft Model A330-300	Height
(1) Fuselage	5.6m
(2) Wing Tip	6.4m
(3) Wing / Fuselage	4.0m
(4) Tail Plane	7.5m
(5) Engine Nacelle	4.3m

Aircraft Model 767	Height
(1) Fuselage	7.2m
(2) Wing Tip	4.9m
(3) Wing / Fuselage	4.5m
(4) Tail Plane	5.8m
(5) Engine Nacelle	4.6m

Aircraft Model A320	Height
(1) Fuselage	4.1m
(2) Wing Tip	4.0m
(3) Wing / Fuselage	3.5m
(4) Tail Plane	5.4m
(5) Engine Nacelle	3.0m

Specifications and Dimensions are subject to change without notice. Note: all listed dimensions have a tolerance +/- 200mm